

# Guthrie Lakes • *The Enchanted Forest* •

## A pristine residential resort community in the heart of growing northern Michigan.

Nestled deep in the forested hills of booming Otsego County – the golf and winter sports mecca of the Midwest – the residential resort community of Guthrie Lakes is truly unique.

Located only 15 minutes south of the bustling Alpine-themed village of Gaylord, Guthrie Lakes is still relatively undiscovered. It's a hidden paradise of sparkling lakes, sandy beaches and quiet streets winding past homes and parks set in the midst of mature trees. All just a few miles off of I-75.

Our Property Owners, the lucky folks who live and vacation here, call Guthrie Lakes their "private" piece of heaven. And every effort is made to keep it that way. The forested character of Guthrie Lakes is maintained by not permitting clear cutting of trees. All home construction is strictly regulated and controlled. And the amenities and facilities are professionally managed.

By protecting those things which make Guthrie Lakes so unique, we also help protect the investment our Property Owners have made in their homes and property. It's what makes Guthrie Lakes the very special place that it is!

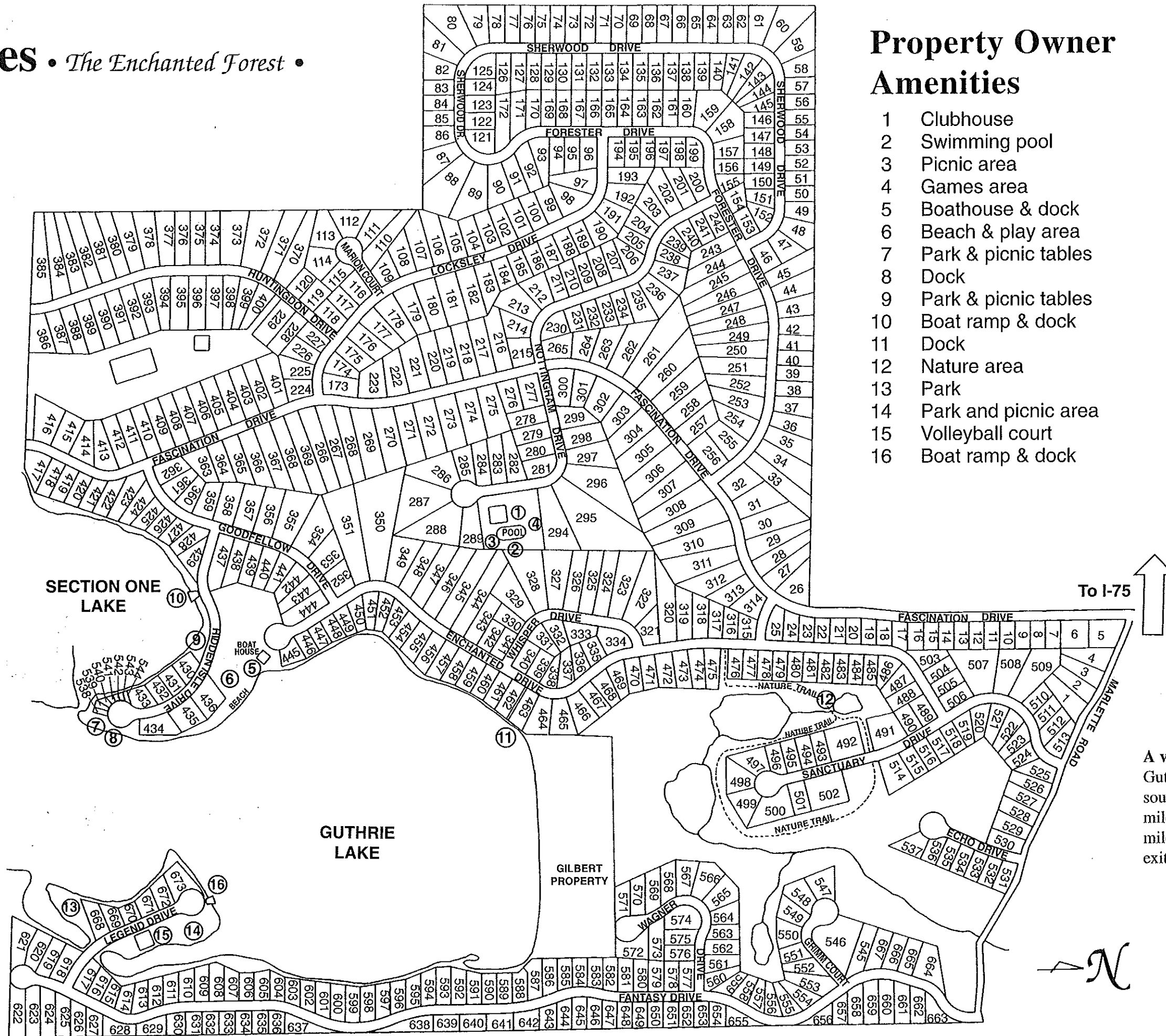

## Property Owner Amenities

- 1 Clubhouse
- 2 Swimming pool
- 3 Picnic area
- 4 Games area
- 5 Boathouse & dock
- 6 Beach & play area
- 7 Park & picnic tables
- 8 Dock
- 9 Park & picnic tables
- 10 Boat ramp & dock
- 11 Dock
- 12 Nature area
- 13 Park
- 14 Park and picnic area
- 15 Volleyball court
- 16 Boat ramp & dock

A very convenient location. Guthrie Lakes is fifteen miles south of Gaylord and fifteen miles north of Grayling, four miles east of I-75 (the Waters exit 270) on Marlette Road.